

Trees

adjacent to, or within, a wetland, creek or greenbelt cannot be cut down without City approval. Tree removal in these areas may violate environmental regulations and could result in fines.

The City of Kent offers a free service to review and inspect trees within wetlands, creeks or greenbelts on your property to ensure they are safe to cut. Please complete this form and return to:

City of Kent Development Engineering, ECD
Centennial Center, 3rd Floor
400 W. Gowe Street, Kent, WA 98032

Questions?

Call: 253.856.5490

E-mail: callb4ucut@KentWA.gov



City of Kent Development Engineering, ECD
400 W. Gowe Street | Kent, WA 98032

253.856.5490 | callb4ucut@KentWA.gov
KentWA.gov



Tree Removal/Pruning Request

Please allow a minimum of 10 working days for the City response to this request.

- A report from a certified arborist is required with this application if the tree is located in a critical area. This approval, if granted, is valid for six (6) months from the date of issuance.
- Applicant shall be required to comply with all City codes, ordinances and resolutions in effect as of the date of the issuance of this approval.

Requestor Name: _____ Phone: _____
(please print)

Mailing Address: _____

E-mail: _____

I, the undersigned, grant permission for public officials and staff of the City of Kent to enter the subject property for the purpose of inspection and posting attendant to this application.

Owner Signature (acknowledging and supporting request) _____

1. Draw Site Plan Here

- Please show all trees
- Number each tree to be removed/pruned
- Show buildings, roads, property lines and known easements

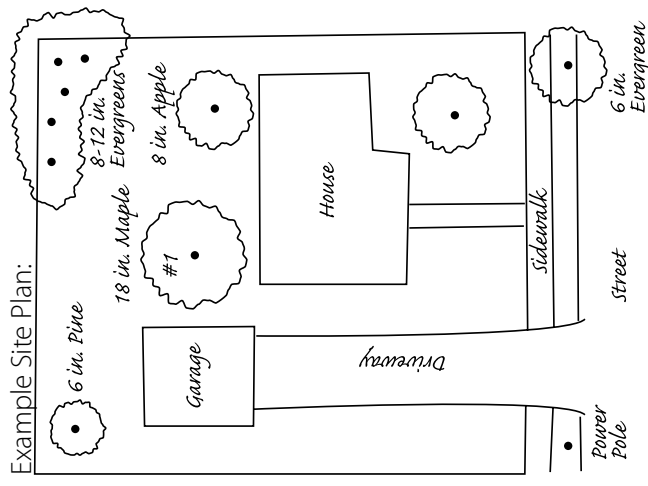

2. List the trees (private and/or public) proposed to be removed and/or pruned

For City Use

Use additional forms if requesting to remove more trees than space provides.

Tree # from site plan	Type/Species (if known)	Size (dia)*	Location	Reason for removal/pruning	Public tree?	Public Inv #
(example) #1	Big-leaf Maple	18"	East of garage behind house	Remove — rotten in the middle	no	

*Measure or estimate the diameter of the tree trunk at 4½ feet above the ground. Note if there is more than one trunk per tree.